

# Turnkey

Brewery Plants

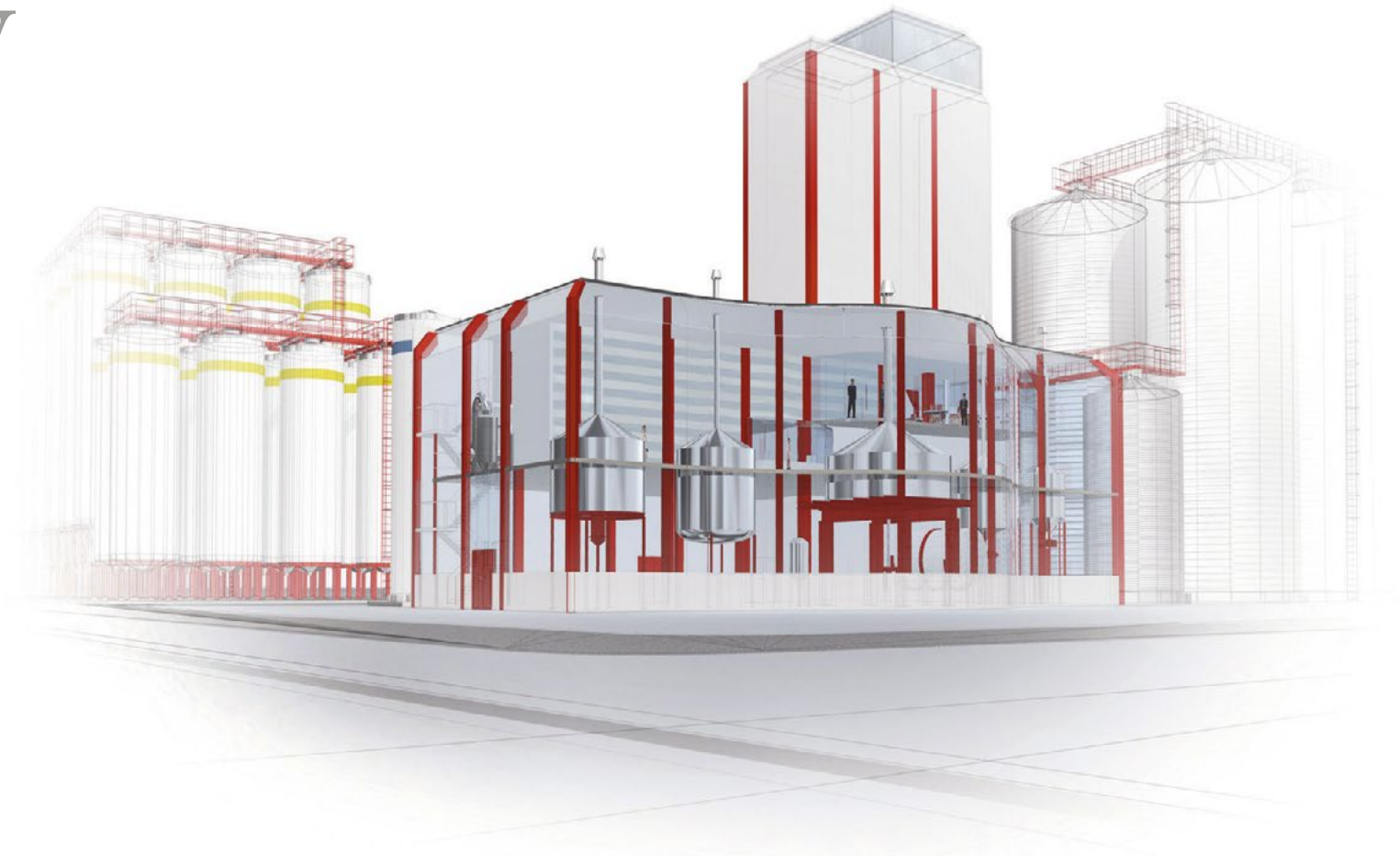

## 4 Steps to a complete brewery – our all-round care-free package for your profitable investment

The advantages:

- Complete brewery from one source
  - Extensive competence
  - Smooth interfaces
  - Fast communication
  - Seamless integration
  - Own research and development
  - Decades of experience with brewing plants all over the world
  - First-class service
-

# 1 Feasibility Study: Who is producing which beer and for whom?

The first step to a turnkey brewery: What is feasible? With our feasibility study we reveal all options within the scope of your specified requirements: beer types, recipes, volumes, engineering, product design in the Ziemann Holvrieka pilot plant, marketing consultation services.



Detailed preparation work: Thorough research,  
wellfounded information, clear-cut perspectives.

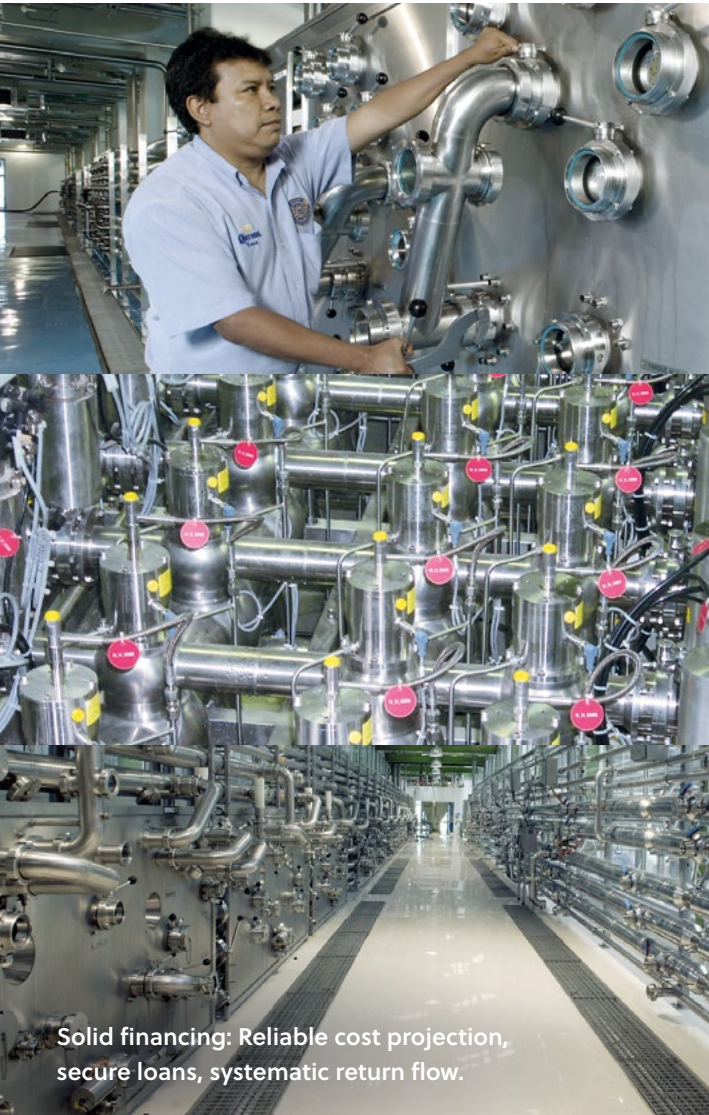

Solid financing: Reliable cost projection, secure loans, systematic return flow.

## 2 Financial Planning: What investments are required?

The second step to a turnkey brewery: Where are the funds coming from? Ziemann Holvrieka assists you in the organization of a solid financing and audits the costs in each stage. Plan: speedy return of the investment.

### 3 Engineering and Design: Which type of machinery and under which roof?

The third step to a turnkey brewery: What equipment is really needed? Exact planning of the production plant down to the last detail. Each vessel, each door and each transport route can be viewed in 3-D imaging by means of CAD. P&I diagrams describe the applied techniques and technology. Foreseeable market developments and expansion phases are also taken into account.



## 4 Implementation: When will beer start to flow?

The fourth step to a turnkey brewery: implementation within cost and schedule estimate. With all technical and technological innovations including automation. Accomplishment of all guaranteed values. Training of personnel on the spot or at the Ziemann Holvrieka pilot plant. Start-up and handing over of the plant. Technical and technological service.





Thank you for your time.

For all enquiries, please contact one of our sales team at a Ziemann Holvrieka office near you.

Scan the QR code or visit [www.ziemann-holvrieka.com](http://www.ziemann-holvrieka.com)

